

REVISION RECORD			
REV	ECO	DESCRIPTION	DRFT

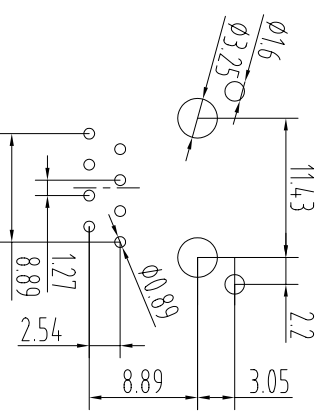
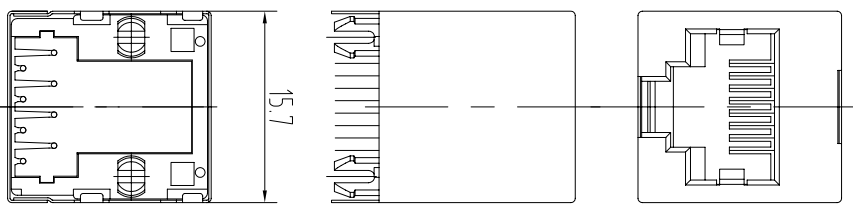
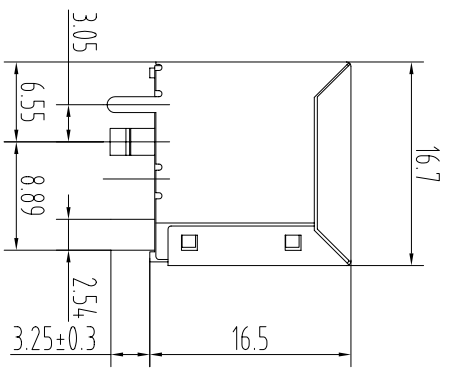

PC Board Layout  
Component Side Shown

**NOTES:**

**MATERIAL :**

- 1. HOUSING MATERIAL
- 2. CONTACT MATERIAL
- 3. PLATING

**ELECTRICAL:**

- 1. VOLTAGE RATING : 125 VAC RMS.
- 2. CURRENT RATING : 15 AMP.
- 3. CONTACT RESISTANCE : 30 MILLIOHMS MAX.
- 4. INSULATION RESISTANCE : 500 MEGOHMS MIN @ 500V DC.
- 5. DIELECTRIC WITHSTANDING RESISTANCE : 1000V AC RMS 50Hz. MIN.

**MECHANICAL:**

- 1. DURRABILITY : 750 CYCLES MIN.
- 2. PCB RETENTION PRE-SOLDER : 1 LB. MIN.

**ENVIRONMENTAL:**

- 1. STORAGE : -40°C ~ +85°C
- 2. OPERATION : 0°C TO 70°C

**PART NUMBER:**

HY52E X X X X X X X X X X X X X X  
S2E TOP ENTRY PCB JACK

POSITIONS	CONTACTS	PORTS	SHIELD	PEGS/TABS	PLASTIC	COLOR	LOGO	GOLD PLATING
1-4 POSITIONS 6-8 POSITIONS	1-4 CONTACTS 6-8 CONTACTS	1-1x1 2-1x2 4-1x4 6-1x6 8-1x8	0-W/O SHIELDED 1-W/ SHIELDED	0-W/O PEG 1-FRONT PEG 3.05 2-FRONT PEG 3.08 3-FRONT PEG 4.57 4-BACK PEG 3.05 5-FRONT PEG 3.50	1-ABS 2-NYLON66 3-NYLON66 4-IVORY	1-BLACK 2-WHITE 3-GRAY 4-IVORY	0-W/O LOGO 1-W/ HTE 2-W/ UL 3-W/ H7EXUL	1-15u" 2-3u" 3-5u" 4-15u" 5-20u" 6-50u"

**DETACHED LISTS**

MM	INCH
0.125	1/8
0.0625	1/16
0.03125	1/32
0.015625	1/64
0.0078125	1/128

DRW	XY	DATE
CHD		05/05/11
CHKD	DATE	
MFO		
APPL	DATE	

**HONG YU ELECTRONIC CO., LTD**

**TITLE**  
S2E 1X1 TOP ENTRY PCB JACK 8P8C

**DRAWING NO.**  
/PART NO.

**SCALE :**

**DO NOT SCALE DRAWING**

**FINISH :**

**QTY :**

**MATERIAL :**

**ANGLES : 0.5**

**THIRD ANGLE PROJECTION**

SIZE	REV
A3	0

SHEET OF